

## DP27 and DP27 Kits,

### Technical Data Sheet

#### System Overview

The DP27 is a 27-litre powder coated mild steel vacuum chamber with a welded construction. It features an acrylic lid and front facing 1/2" BSP manifold and an additional 1/2" BSPP accessory port in the rear. The manifold has a brass hose nozzle for connecting a 1/2" bore hose.

Our DP chambers are compliant with ASTM D3078- 02 and ISO 20484 testing standards, they are pressure tested to  $1 \times 10^{-2}$  mbar and helium leak tested.

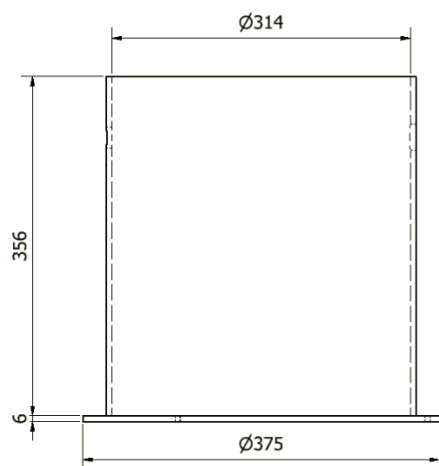

#### Our Full Degassing Pot Range



Model	Volume (Litres)	Internal Dimensions $\varnothing \times H$ (mm)
DP9	9	206 x 270
DP27	27	311 x 356
DP42	42	373 x 381
DP76	76	460 x 460
DP118	118	500 x 600
DP250	250	600 x 900



#### Specifications

- Internal Dimensions: 311mm  $\varnothing$  x 356mm H
- Capacity - 27 Litres
- Weight - Approximately 22kg
- Material – Powder coated mild steel
- Sealing Face – Nitrile L Gasket
- Clear cast acrylic lids
- AVE 63mm glycerine filled indication gauge
- Vacuum isolation valve and air admittance ball valve with pneumatic silencer

#### Options/Extras

- AVE Lid Mounted Stirrer (0-133 or 0-200 RPM)
- 0 – 180°C Heater Platform
- Electrical vacuum feedthroughs
- Additional KF or BSP ports
- IRV20 vacuum regulator (Max flow 240L/min)
- Traceable or UCAS gauge calibration
- Upgrade to a stainless-steel pot and fittings

#### DP27 Vacuum Kits

If you require a complete system, our DP vacuum kits are an excellent option. When sold as a kit we offer a 10% discount on all DVP pumps. Our DP kits come complete with; a vacuum chamber, a vacuum pump, a vacuum manifold and 2 meters of vacuum hose.

MODEL	VACUUM PUMP	NOMINAL CAPACITY (M <sup>3</sup> /H)	EVACUATION TIME*
DP27K8	DVP LC.8	8	1:16
DP27K12	DVP LC.12	12	0:50

\* The evacuation time has been calculated assuming a clean and empty chamber. This is the approximate Min:Sec it will take for the chamber to be evacuated from atmospheric conditions to 2mbar.